

Or Land To be Acquired Permanently For Kopai South Main Canal
 Mouza Amganye Ul no 30 Thana Ketiuham District Burdwan
 Scale: 330 = 1"

Dian

Reference:-
 Land To be Acquired Shown Thick
 Mouza Boundry Shown Thin

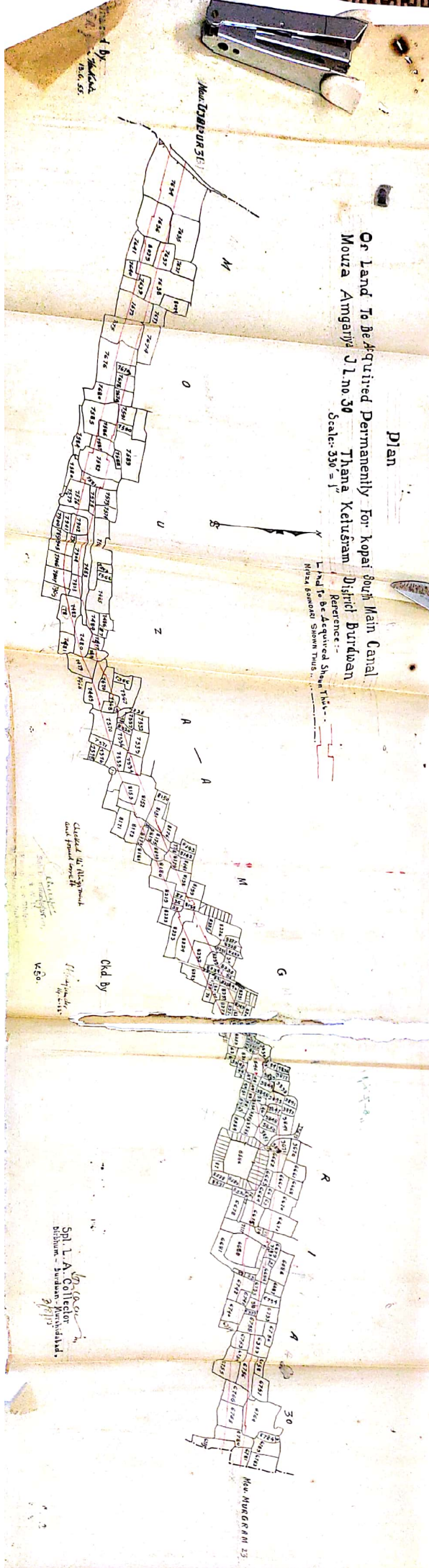

Spl. L. A. Collector
 Division - Burdwan Ketiuham
 1/1/1911

PLAN
OF LAND TO BE ACQUIRED PERMANENTLY FOR EXCAVATION
OF KOPRI SOUTH MAIN CANAL P.S. KETUGRAM
DISTRICT--BURDWAN
Scale 3500:1

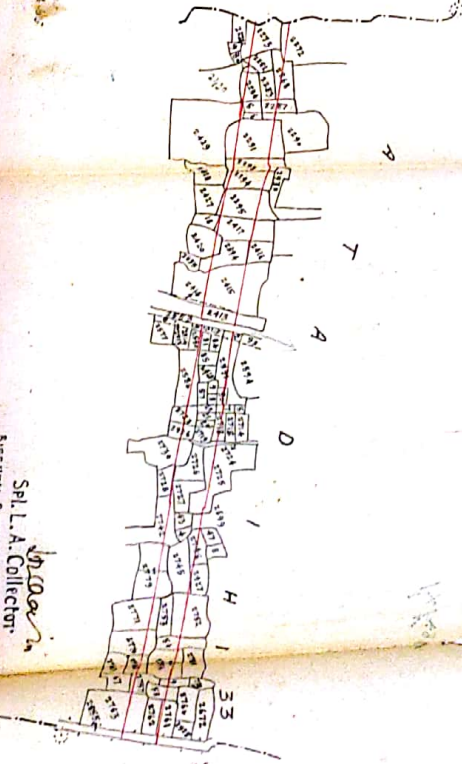

Mouza-Kurmangan

Spl. L. A. Collector
SHERON, BURDWAN, MESSINGALD.

CKD BY
KGO.

Checked by
S. K. Das
S. K. Das
S. K. Das

TRACED BY
S. K. Das
S. K. Das

REFERENCES
Land to be Acquired Permanently Shown Thus ..
Mouza Boundary Shown Thus ..

SHEET No: (1)

Mr. KATADIRI 33

TRACED BY
D. S. S. S.
06/155

Checked by P. K. S. S.
and found correct

10/11/1955

Hydrographic
K.G.O.

C.K.D. BY

Checked by
S. L. K. Collector
BIRSHU, BHOVAN, MURSHIDABAD.
2/1/11

Mr. ANSARI

PLAN
OF LAND TO BE ACQUIRED PERMANENTLY FOR EXCAVATION
OF KOPRI SOUTH MAIN CANAL R. KETUGRAM
DISTRICT - BURDWAN
Scale - 330 = 1"

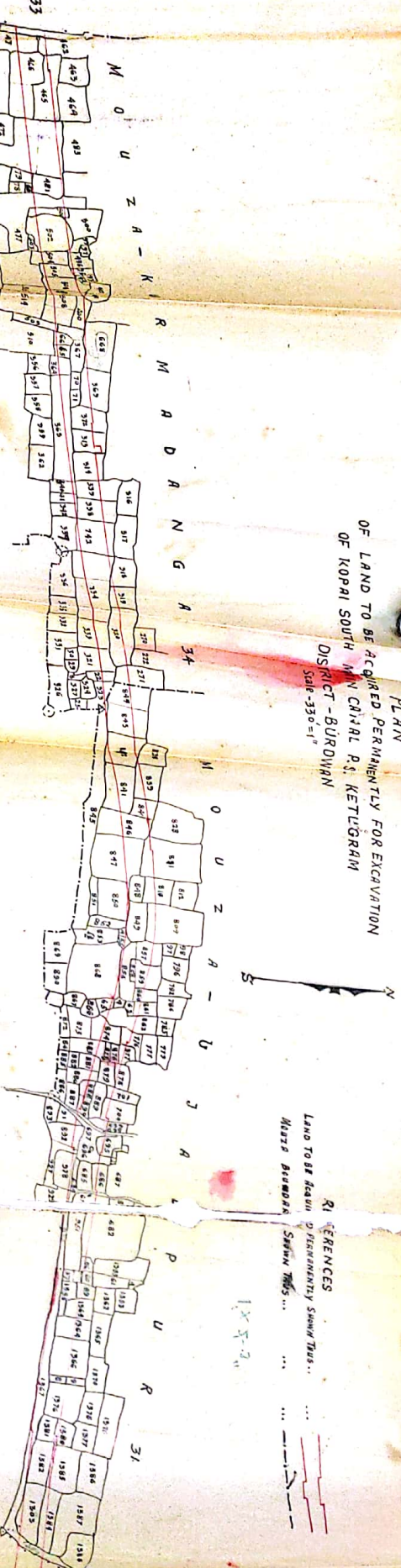

REFERENCES
LAND TO BE ACQUIRED PERMANENTLY SHOWN THUS...
Muzza Burdwan SHOWN THUS...
...

1 x 5 = 2



SHEET

PLAN OF LAND TO BE ACQUIRED PERMANENTLY FOR EXCAVATION OF HOPAI SOUTH MAIN CANAL. THANA-RETUGRAM. DISTRICT--BURDWAN. Scale--350'-1"

References:- Land to be Acquired from Nos:-

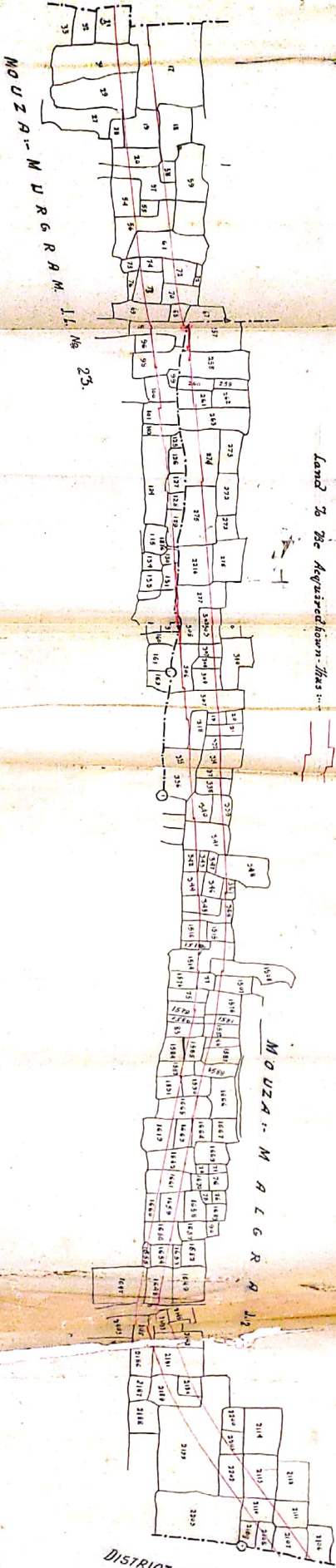

TRACED BY: P.R. Ghosh, Thakurde 13.6.55.

Checked by: [Signature]

CHD. BY: [Signature]

Spl. L. H. COLLECTOR, DISTRICT-BURDWAN-MURSHIDABAD. 3/7/55

DISTRICT--MURSHIDABAD

SHEET (4)